

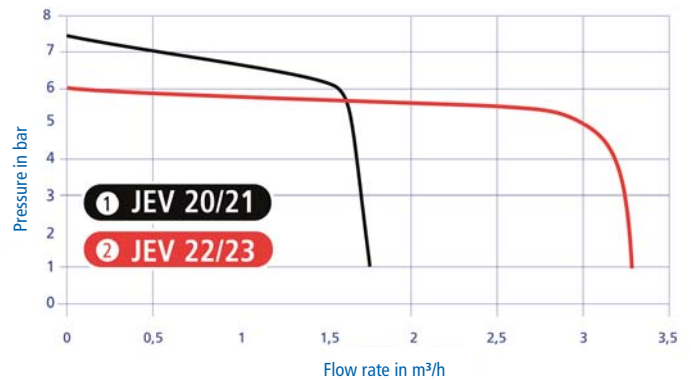

> SPECIAL OIL ELECTRO-PUMPS : SELF-PRIMING VOLUMETRIC VANE PUMPS JEV20/ JEV21 / JEV22 / JEV23

JEV20 / JEV22 230 Volt single-phase motor
 JEV21 / JEV23 230 / 400 Volt three-phase motor



APPLICATION SECTOR :

Transfer of oils : from 10 to 500 Cst (mm²/s)
 Industry, agriculture, construction, ...

PUMP CHARACTERISTICS :

Built-in and adjustable bypass (except JEV22 pump : fixed bypass)
 Positioning : horizontal or vertical
 Maximum inlet height : 5 m for 50 mm²/s
 Maximum temperature of liquid to be pumped : 60°C
 Ambient operating temperature : -10°C to 60°C

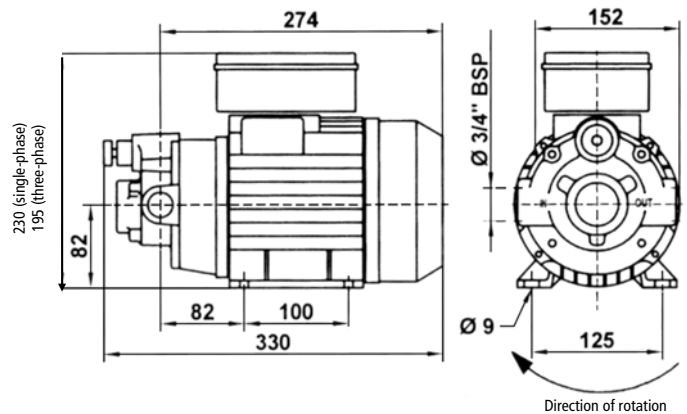

MOTOR CHARACTERISTICS :

REFERENCE	INLET AND OUTLET DIAMETER	WEIGHT in kg	MAX FLOW RATE in m³/h	MAX HEIGHT in m
JEV20	1"	14,3	1,5	60
JEV21	1"	12,8	1,5	60
JEV22	1"	14	3	50
JEV23	1"	15	3	50

REFERENCE	TYPE	POWER in kw	VOLTAGE in volt	CURRENT in ampere	ROTATION SPEED
JEV20	Single-phase	0,75	230	4,6	1400 rpm
JEV21	Three-phase	0,75	400	2,2	1400 rpm
JEV22	Single-phase	1,6	230	7,8	1400 rpm
JEV23	Three-phase	2	400	5	1400 rpm

ADDITIONAL ACCESSORIES :

Outlet equipment
 4 m standard length
 Ref. : RF25H



10 micron oil cartridge
 + adaptor 1"
 Ref. : TUF611



Inlet equipment
 1 m standard length
 Ref. : AS32

